

# MEDIEVAL MAKEOVER



Master bath renovation fit for  
a king, and his queen

Story by Maria Sonnenberg • Photography by Rob Downey

WHICHEVER POSSIBLE:  
ALL SWITCHES ON TIMMERS,  
STYLE TO MATCH EXISTING

REPLACE  
LT. FIXTURE

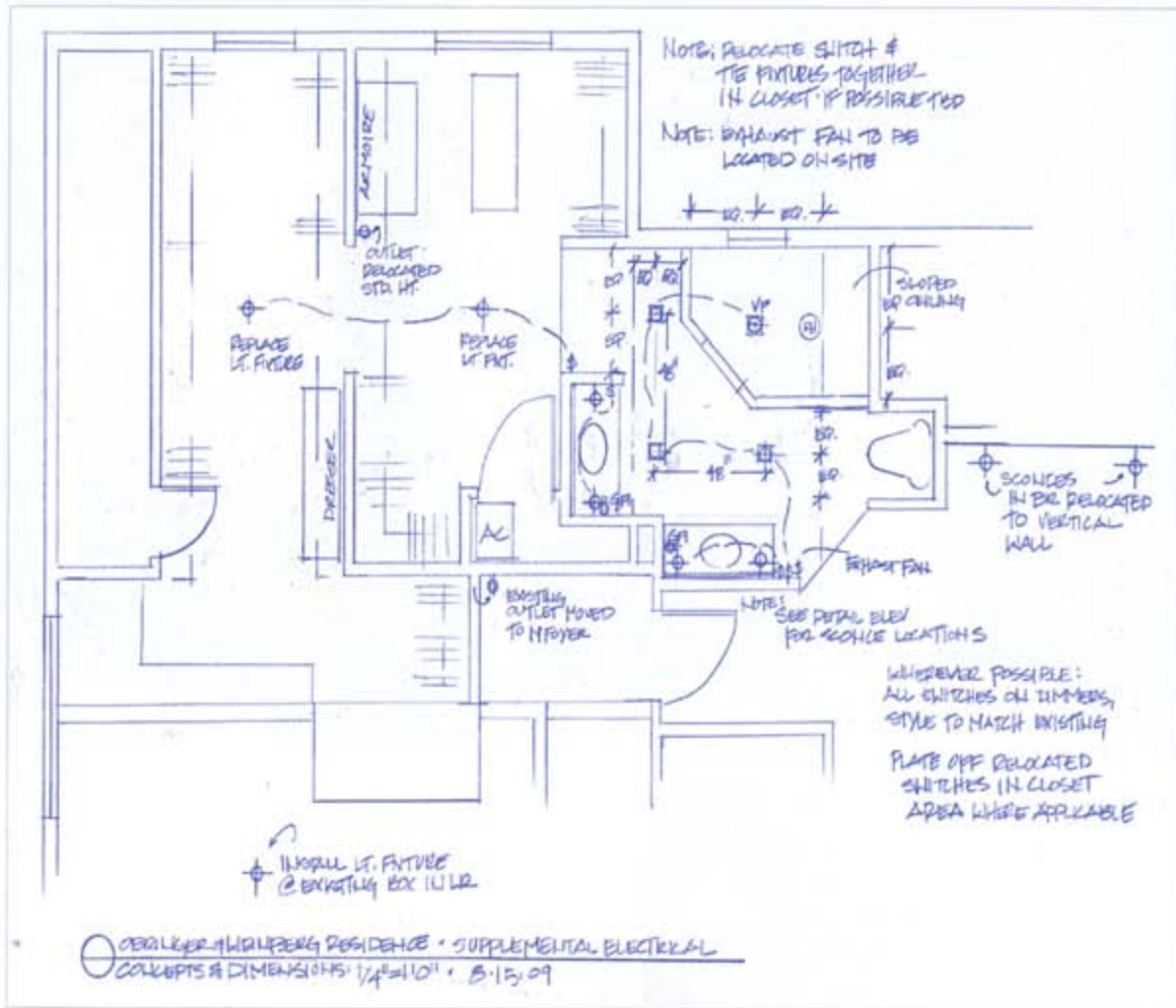

INSTALL LT. FIXTURE @ EXISTING BOX IN LR.

A man's home is his castle, particularly if the guy in question is Tom Obringer.

Obringer's Merritt Island home, a Tudor beauty from the 1980s, is a commanding presence with angles, arches and rich architecture that make this historical style regal.

Wife Sheri is a dedicated Anglophile who collects medieval and gothic furnishings for the couple's 3,000-plus-square-foot-home and grows heirloom roses on the property, which overlooks Stillwater's scenic Honeymoon Lake.

Although Tom and Sheri loved the house they moved into in 1999, the couple had no passion for the original – and style-less – bathroom in the upstairs master retreat. The space also offered such unusually miserly closet space that Tom and

Sheri were forced to hoard their clothing in nooks and crannies downstairs.

Enter interior designer Christine Whiteley, who in a couple of months transformed the Obringer's oh-so-inadequate bathroom and master closet into rooms fit for a king, and his queen, of course.

Taking a cue from Sheri's deep admiration for all things British, the owner of Concepts and Dimensions residential design services journeyed to the past to create a space that would satisfy the Obringers' sense of history, as well as their need for 21st century amenities.

"I wanted it English and medieval...and I wanted a big shower," says Sheri.

Whiteley did her homework, searching for

**Left:** Interior designer, Christine Whiteley journeyed to the past to create a space that would satisfy her clients' sense of history, as well as their desire for 21st century amenities. **Above:** Whiteley's original sketches for the remodel project.



**Above:** The renovation involved borrowing space from an unused loft and tiny bedroom; and re-designing that space to be a custom walk-in closet. **Above right:** A one-piece pre-fabricated shower stall and garden tub were transformed into an expansive walk-in shower. **Right:** "Before" photos of original shower and tub.

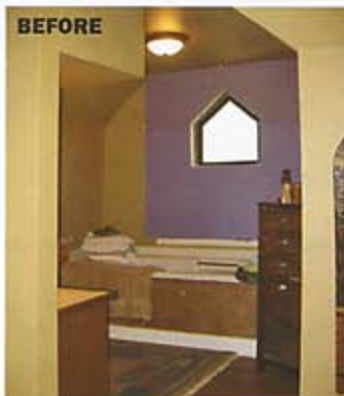

textures and shapes that would reflect Sheri's desire.

"The materials we used all have a historical reference," she says.

First on the hit list for contractor Dixon Builders was the old one-piece pre-fabricated shower stall with nary a Tudor hint.

"I called it the phone booth," says Sheri.

"It was barely big enough to turn around in. I wanted to take it out back and shoot it."

At right angles to the shower was a very ordinary sink. The old sink and shower were removed and transformed into handsome his and hers oak cabinetry custom-built by Balcavage Custom Furniture and Cabinetry. Two new sinks were also installed.

One of Whiteley's clever touches was the bank of apothecary drawers built into the wall between the cabinetry.

"It helps them keep small things in order," says Whiteley.

Reconfiguring the corner and removing the nonstructural soffit opened a vista of ceiling lines that complement the home's Tudor pedigree.

Across from the cabinetry, Whiteley replaced the aging garden tub with an expansive walk-in shower. To evoke a castle effect, Whiteley clad the shower's largest wall with travertine tile set in a brick pattern from Stone and Surface Designers, installed by Moonlight Tile. Whiteley selected rhomboid tiles for one of the walls and pebble tiles on the shower floor by Ceramic Matrix, to continue the medieval theme. Moonlight Tile also handled this installation.

The shower, wrapped in rich wainscoting evokes the feel of

One of Whiteley's clever touches was the bank of apothecary drawers built into the wall between the cabinetry.

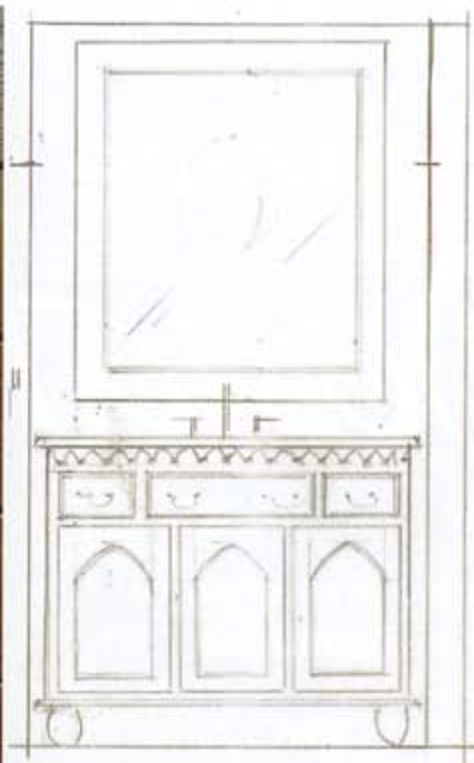

*Left: The completed space includes handsome his and hers custom oak cabinetry and new sinks. The angles, arches and colors of this historical style are evident in the regal drawer pulls and the oil-rubbed bronze finish on the faucet and handles.*

**SOURCES:**

**Design:**

Concepts and Dimensions

**Contractor:**

Dixon Builders LLC

**Supplier:**

Balcevage Custom Furniture

and Cabinetry, Inc.

Cabinetry & Wainscot

**Supplier:**

Stone & Surface Designers,

Inc. travertine and slate

**Supplier:**

Ceramic Matrix- rhomboid

tile and pebble tile

**Installation:**

Moonlight Tile

**Closets:**

Closet City

an ancient British manor. The shower is fed by both rain and traditional shower heads with an oil-rubbed bronze finish that mirrors the period-perfect light fixtures Whiteley selected online from Rejuvenation Lighting.

Outside the shower, Whiteley's flooring design called for slate set in a hopscotch pattern, again to reflect a British influence.

The purposeful renovation involved borrowing space from an unused loft and a tiny bedroom adjacent to the bath.

"We cut through that space and made it the master closet," says Whiteley.

"We reallocated both the bedroom and the typical 1980's loft into a custom master closet with access only from the master bath, so it became private space."

A closet designed by Closet City of Vero Beach creates a spacious dressing room adjacent to the new bath. The space features a pullout ironing board, his and hers hampers and a marble-topped island.

Whiteley credits the project's success to her clients' very different approaches.

"Sheri has the artist's mentality, so she's great at visualization, while Tom, who's an engineer, got very involved in the details of the process," she says.

To view a portfolio of Concepts and Dimensions projects, visit [www.conceptsanddimensions.com](http://www.conceptsanddimensions.com). Whiteley can be reached at 321-504-3966. ■

"Sheri has the artist's mentality, so she's great at visualization, while Tom, who's an engineer, got very involved in the details of the process."

- CHRISTINE WHITELEY